

Prelungitor lung de IMPACT 1/2" - 231.4/4

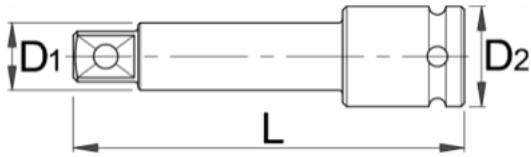

Descriere

- material:crom molibden
- forjata, calire si revenire totala
- acoperire prin brunare dupa standardul DIN 12476

Date Tehnice

Barcode	Size	L	D1	D2	Weight	Material	Coating	Other
603978	1/2"	75	16.9	25	148	1E	5	0
603977	1/2"	125	16.9	25	230	1E	5	0

Date de ambalare

Barcode	Mod de reambalare.				Ambalare pentru transport.					
	L	A	B	C	Weight	Material	A1	B1	C1	Other
603978	75	125	100	25	148	1	-	-	-	-
603977	125	235	80	25	230	1	-	-	-	-