

Capete chei tubulare 3/4" - 197/1 6p

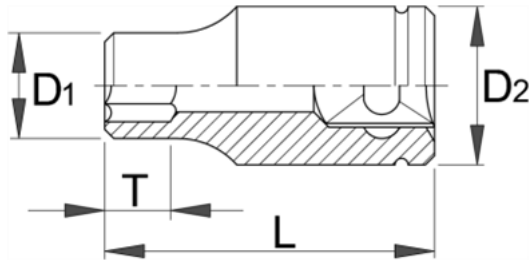

Descriere

- material:crom vanadiu
- forjata, calire si revenire totala
- acoperire cromare conform EN12540
- polizate
- executie in concordanta cu standardul ISO 2725-1 (numai pentru dimensiunea in mm)

Date Tehnice





Barcode	Hex	D1	D2	L	T	Weight	Material	Polish	Coating
619698	19	29.2	32.9	50	14.5	-	-	10	0
602723	22	32.2	36	50	14	220	B	10	0
602724	23	33.2	36	50	14	221	B	10	0
602725	24	34.2	36	51	16	230	B	10	0
602726	26	37	36	52	16	230	B	10	0
602727	27	38	36	52	22	239	B	10	0
602728	28	39	36	52	22	242	B	10	0
619702	29	38	40.6	51.8	24.1	270	B	10	0
602729	30	42	38	54	24	273	B	10	0
602730	32	44	38	56	26	295	B	10	0
602731	34	47	38	56	26	347	B	5	0
619701	35	42.1	48.2	58	30.3	401	B	5	0
602732	36	50	42	58	28	400	B	5	0
602733	38	52	45	60	28	488	B	5	0
602734	41	56	45	64	30	502	B	5	0
602735	46	62	48	68	34	621	B	1	0
602736	50	68	48	72	36	708	B	1	0
617527	55	74	48	76	32	914	B	1	0
603135	60	80	48	78	42	1105	B	1	0
609383	7/8"	32.2	36	50	14	220	B	10	0
609384	15/16"	34.2	36	51	16	231	B	10	0
609385	1"	37	36	52	16	234	B	10	0
609386	1.1/16"	38	36	52	22	224	B	10	0
609387	1.1/8"	40	38	52	22	265	B	10	0
609388	1.1/4"	44	38	56	24	313	B	10	0
609389	1.5/16"	46	38	56	26	336	B	5	0
609390	1.3/8"	48	42	58	26	406	B	5	0
609391	1.7/16"	50	42	58	28	415	B	5	0
609392	1.1/2"	52	45	60	28	414	B	5	0
609393	1.5/8"	56	45	64	30	572	B	5	0
609394	1.11/16"	58	45	65	32	595	B	5	0
609395	1.13/16"	62	48	68	34	698	B	1	0
609396	1.7/8"	64	48	70	34	741	B	1	0
609397	2"	68	48	72	36	842	B	1	0
609398	2.1/16"	70	48	72	36	879	B	1	0

Date de ambalare

Barcode	Hex	Mod de reambalare.			Ambalare pentru transport.					
		A	B	C	Weight	Hand	A1	B1	C1	Weight
619698	19	-	-	-	-	-	-	-	-	-
602723	22	162	58	36	230	1	65	185	46	280
602724	23	162	58	36	230	1	65	185	46	280
602725	24	163	58	36	240	1	65	185	46	290
602726	26	162	58	37	240	1	65	185	46	290
602727	27	162	58	37,8	240	1	65	185	46	290
602728	28	162	58	39,5	255	1	65	185	46	305
619702	29	162	58	40,6	285	1	65	185	46	335
602729	30	165	58	42	285	1	70	191	55	345
602730	32	167	58	44,1	300	1	70	191	55	360
602731	34	167	58	47,2	340	1	70	191	55	400
619701	35	167	58	48	360	1	70	191	55	420
602732	36	167	58	50	400	1	70	191	55	460
602733	38	170	58	52,1	430	1	80	200	63	505
602734	41	173	58	56,1	505	1	80	200	63	580
602735	46	180	62	62	635	1	86	205	69	720
602736	50	184	68	68	725	1	95	210	75	825
617527	55	190	74	74	945	1	100	215	85	1057

Mod de reambalare.

Ambalare pentru transport.

 	Mod de reambalare.			Ambalare pentru transport.						
	A	B	C			A1	B1	C1		
603135	60	190	80	80	1120	1	100	215	85	1232
609383	7/8"	162	58	36	230	1	65	185	46	280
609384	15/16"	163	58	36	240	1	65	185	46	290
609385	1"	162	58	37	240	1	65	185	46	290
609386	1.1/16"	162	58	37,8	240	1	65	185	46	290
609387	1.1/8"	162	58	40,1	260	1	65	185	46	310
609388	1.1/4"	167	58	44,1	330	1	70	191	55	390
609389	1.5/16"	167	58	47,2	340	1	70	191	55	400
609390	1.3/8"	170	58	48	365	1	80	200	63	440
609391	1.7/16"	167	58	50	430	1	70	191	55	490
609392	1.1/2"	170	58	52,1	430	1	80	200	63	505
609393	1.5/8"	173	58	56,1	585	1	80	200	63	660
609394	1.11/16" "	176	58	58	600	1	80	200	63	675
609395	1.13/16" "	180	62	62	715	1	86	205	69	800
609396	1.7/8"	180	64	64,1	770	1	86	205	69	855
609397	2"	184	68	68	855	1	95	210	75	955
609398	2.1/16"	185	70	69,8	885	1	95	210	75	985