

Capete de IMPACT varianta lunga - 233/4L6p

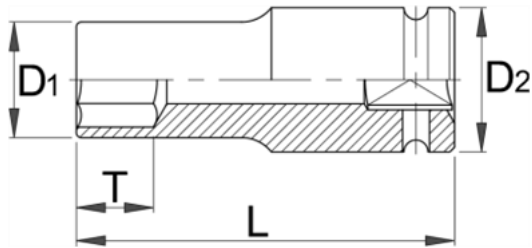

Descriere

- material:crom molibden
- forjata, calire si revenire totala
- acoperire prin brunare dupa standardul DIN 12476

Date Tehnice

Barcode	Hex	D1	D2	L	T	Weight	Material	Coating	Quantity	Unit
616771	22	40	54	100	21	879	C	5	0	
616772	24	42	54	100	21	921	C	5	0	
616773	27	46	54	100	24	1012	C	5	0	
616774	30	50	54	100	24	1075	C	5	0	
616775	32	52	54	100	24	1090	C	5	0	
616776	33	53	54	100	24	1109	C	5	0	
616777	34	55	54	100	40	1162	C	5	0	
616778	36	56	54	100	65	1207	C	5	0	
616779	38	59	54	100	65	1222	C	5	0	
616780	41	63	54	100	64	1367	C	5	0	
616781	42	64	54	100	64	1380	C	5	0	
616782	46	69	54	100	63	1613	C	1	0	
616783	50	74	54	100	62	1793	C	1	0	
616784	55	80	54	100	60	1976	C	1	0	
616785	60	86	54	120	78	2726	C	1	0	
616786	65	92	54	125	80	3192	C	1	0	
616787	70	99	54	125	80	3595	C	1	0	
616788	75	104	86	135	85	4512	C	1	0	
616789	80	109	86	135	85	5532	C	1	0	

Date de ambalare

Barcode	Hex	Mod de reambalare.					Ambalare pentru transport.			
		A	B	C	Weight	Quantity	A1	B1	C1	Weight
616771	22	54	100	54	884	1	-	-	-	-
616772	24	54	100	54	926	1	-	-	-	-
616773	27	54	100	54	1017	1	-	-	-	-
616774	30	54	100	54	1080	1	-	-	-	-
616775	32	54	100	54	1095	1	-	-	-	-
616776	33	54	100	54	1114	1	-	-	-	-
616777	34	55	100	55	1167	1	-	-	-	-
616778	36	56	100	56	1212	1	-	-	-	-
616779	38	59	100	59	1227	1	-	-	-	-
616780	41	63	100	63	1372	1	-	-	-	-
616781	42	65	100	65	1385	1	-	-	-	-
616782	46	69	100	69	1618	1	-	-	-	-
616783	50	74	100	74	1798	1	-	-	-	-
616784	55	80	100	80	1981	1	-	-	-	-
616785	60	86	120	86	2731	1	-	-	-	-
616786	65	92	125	92	3197	1	-	-	-	-
616787	70	100	125	100	3600	1	-	-	-	-
616788	75	104	135	104	4517	1	-	-	-	-
616789	80	112	135	112	5537	1	-	-	-	-