

Capete de IMPACT 1.1/2" - 234/4 6p

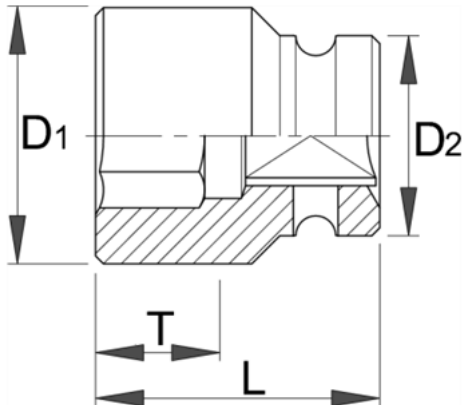

Descriere

- material:crom molibden
- forjata, calire si revenire totala
- acoperire prin brunare dupa standardul DIN 12476
- in conformitate cu standardul ISO 2725-2(numai dimensiunile in mm)

Date Tehnice

Barcode	Hex	D1	D2	L	T	Weight	Material	Coating	ISO 2725-2
616790	80	116	86	110	54	5224	C	1	0
616791	85	125	86	118	52	5688	C	1	0
616793	90	130	86	118	52	6395	C	1	0
616794	95	138	86	118	52	6995	C	1	0
616795	100	140	86	125	59	7995	C	1	0
616796	105	150	95	125	59	8995	C	1	0
616797	110	156	95	125	59	8995	C	1	0
616798	115	160	95	135	67	9035	C	1	0
616799	120	168	95	135	67	10195	C	1	0

Date de ambalare

Barcode	Hex	Mod de reambalare.			Weight	Hand	Ambalare pentru transport.		
		A	B	C			A1	B1	C1
616790	80	115	119	119	5229	1	-	-	-
616791	85	121	125	125	5693	1	-	-	-
616793	90	125	130	130	6400	1	-	-	-
616794	95	121	138	138	7000	1	-	-	-
616795	100	125	144	144	8000	1	-	-	-
616796	105	154	125	154	9000	1	-	-	-
616797	110	125	156	156	9000	1	-	-	-
616798	115	135	160	160	9040	1	-	-	-
616799	120	135	168	168	10200	1	-	-	-