

Capete chei tubulare de IMPACT 3/8" - 230/4 6p

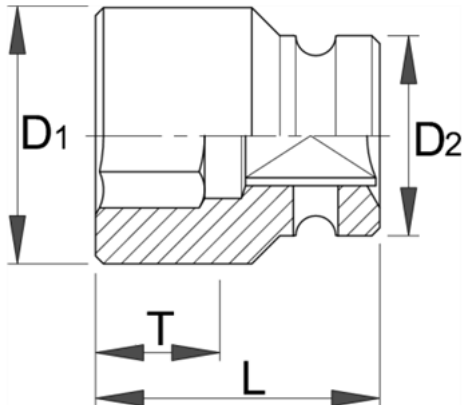

Descriere

- material:crom molibden
- forjata, calire si revenire totala
- acoperire prin brunare dupa standardul DIN 12476
- in conformitate cu standardul ISO 2725-2(numai dimensiunile in mm)

Date Tehnice

Barcode	Hex Size	D2	D1	L	T	Weight	Material	Surface	ISO	Other
612060	8	19	13.8	30	8	45	B	10	0	
612061	9	19	15	30	8	45	B	10	0	
612062	10	19	16.3	30	8	45	B	10	0	
612063	11	19	17.5	30	9	45	B	10	0	
612064	12	19	19	30	9	45	B	10	0	
612065	13	22	20	30	10	61	B	10	0	
612066	14	22	21.3	30	11	55	B	10	0	
612067	15	22	22	30	11	58	B	10	0	
612068	16	22	24	30	12	65	B	10	0	
612069	17	22	25	30	12	65	B	10	0	
612070	18	22	26	30	12	69	B	10	0	
612071	19	22	27.5	30	19	66	B	10	0	
612072	20	22	28	30	13	66	B	10	0	
612073	21	22	30	30	13	73	B	10	0	
612074	22	23	32	30	13	86	B	10	0	

Date de ambalare

Barcode	Hex Size	Mod de reambalare.					Ambalare pentru transport.			
		A	B	C	Weight	Material	A1	B1	C1	Weight
612060	8	100	44	34	50	4	83	131	55	325
612061	9	100	44	34	50	4	83	131	55	325
612062	10	100	44	34	50	4	83	131	55	325
612063	11	100	44	34	50	4	83	131	55	325
612064	12	100	44	34	50	4	83	131	55	325
612065	13	100	44	34	66	4	83	131	55	389
612066	14	100	44	34	60	4	83	131	55	365
612067	15	100	44	34	63	4	83	131	55	377
612068	16	100	44	34	70	4	83	131	55	405
612069	17	100	44	34	70	4	83	131	55	405
612070	18	100	44	34	74	4	83	131	55	421
612071	19	100	44	34	71	4	83	131	55	409
612072	20	100	44	35	71	4	83	131	55	409
612073	21	100	44	36	78	4	83	131	55	437
612074	22	100	44	37	91	4	83	131	55	489