

Capete chei tubulare de impact 1/2" cu profil special de protectie - 231/4NS

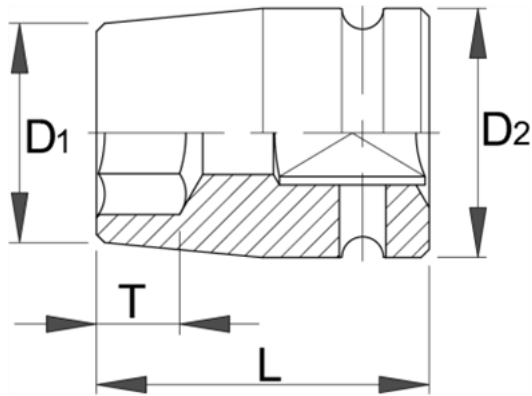

Descriere

- material:crom molibden
- forjata, calire si revenire totala
- acoperire prin brunare dupa standardul DIN 12476
- in conformitate cu standardul ISO 2725-2(numai dimensiunile in mm)

Date Tehnice

Barcode	Hex	D1	D2	L	T	Icon 1	Icon 2	Icon 3
618925	10	15.6	22.6	38.1	7.5	70	B	5 1
619144	11	17.8	22.6	38.1	8.5	72	B	5 1
619145	12	18.2	24.3	38.1	10	85	B	5 1
618926	13	19.3	24.3	38.1	10	85	B	5 1
618927	14	22	24.3	38.1	10.5	87	B	5 1
618928	15	23.2	26.6	38.1	10.5	108	B	5 1
618929	16	24.3	26.6	38.1	12	108	B	5 1
618930	17	25.4	26.6	38.1	12.5	108	B	5 1
618931	18	26.6	26.6	38.1	12.5	108	B	5 1
618932	19	28.3	28.3	38.1	12.5	118	B	5 1
618933	21	31.5	31.5	38.1	14	150	B	5 1
618934	22	33.1	33.1	38.1	14	167	B	5 1
618935	23	33.8	33.8	44.5	16	207	B	5 1
618936	24	34.8	34.8	44.5	16	208	B	5 1
618937	25	36.4	36.4	44.5	19.5	222	B	5 1
618938	26	37.8	37.8	50.8	19.5	276	B	5 1
618939	27	39.4	39.4	50.8	20	287	B	5 1

Date de ambalare

Barcode	Hex	Mod de reambalare.			Ambalare pentru transport.					
		A	B	C	Icon 1	Icon 2	A1	B1	C1	Icon 3
618925	10	105	44	43	75	4	93	144	57	425
619144	11	105	44	43	77	4	93	144	57	433
619145	12	105	44	43	90	4	93	144	57	485
618926	13	105	44	43	90	4	93	144	57	485
618927	14	105	44	43	92	4	93	144	57	493
618928	15	105	44	43	113	4	93	144	57	577
618929	16	105	44	43	113	4	93	144	57	577
618930	17	105	44	43	113	4	93	144	57	577
618931	18	105	44	43	113	4	93	144	57	577
618932	19	105	44	43	123	4	93	144	57	617
618933	21	105	44	44,75	155	4	93	144	57	745
618934	22	105	44	45,55	172	4	93	144	57	813
618935	23	110	44	45,9	212	4	93	144	57	973
618936	24	110	44	46,4	213	4	93	144	57	977
618937	25	110	44	47	227	4	93	144	57	1033
618938	26	120	44	47,65	281	4	93	144	57	1249
618939	27	120	44	48,7	292	4	93	144	57	1293