

## Capete chei tubulare de impact 1" cu 4 laturi - 233/4SQ

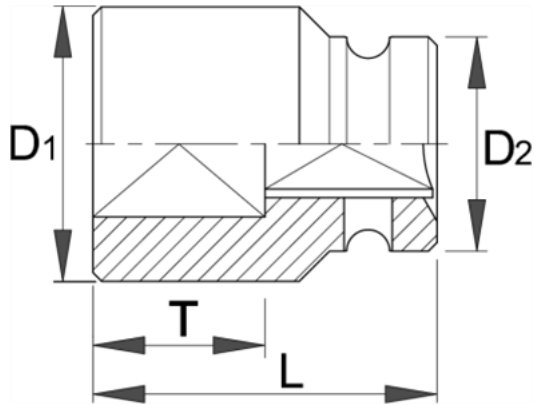

### Descriere

- material:crom molibden
- forjata, calire si revenire totala
- acoperire prin brunare dupa standardul DIN 12476

### Date Tehnice

| Barcode | mm | D1 | D2 | L  | T  | Weight | Material | Surface | Other |
|---------|----|----|----|----|----|--------|----------|---------|-------|
| 618763  | 18 | 42 | 52 | 57 | 24 | 572    | 1C       | 5       | 0     |
| 618764  | 23 | 48 | 54 | 60 | 27 | 672    | 1C       | 5       | 0     |
| 618762  | 1" | 52 | 54 | 60 | 27 | 698    | 1C       | 5       | 0     |

### Date de ambalare

| Barcode | mm | Mod de reambalare. |     |    | Ambalare pentru transport. |    |    |    |   |
|---------|----|--------------------|-----|----|----------------------------|----|----|----|---|
|         |    | A                  | B   | C  | Weight                     | A1 | B1 | C1 |   |
| 618763  | 18 | 52                 | 100 | 52 | 577                        | 1  | -  | -  | - |
| 618764  | 23 | 54                 | 100 | 54 | 677                        | 1  | -  | -  | - |
| 618762  | 1" | 54                 | 100 | 54 | 703                        | 1  | -  | -  | - |