

## Capete chei tubulare 1/2" cu 12 laturi - 190/1 12p

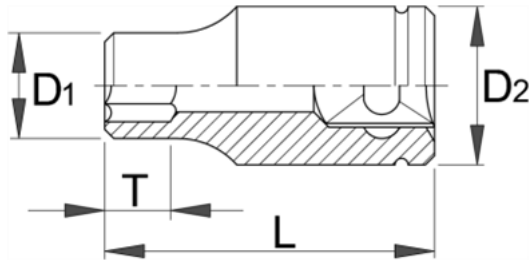

### Descriere

- material:crom vanadiu
- forjata, calire si revenire totala
- acoperire cromare conform EN12540
- polizate
- executie in concordanta cu standardul ISO 2725-1 (numai pentru dimensiunea in mm)

### Date Tehnice





Barcode	Hex Key Icon	D1	D2	L	T ↓	Weight	Material	Surface	Polish
603812	10	15	22.9	38	12	55	B	10	0
603813	11	16.3	22.9	38	12	55	B	10	0
603814	12	17.9	22.9	38	12	65	B	10	0
603815	13	18.8	22.9	38	12	65	B	10	0
603816	14	19.7	22.9	38	12	65	B	10	0
603817	15	20.4	22.9	38	12	65	B	10	0
603818	16	22.9	21.5	38	12	65	B	10	0
603819	17	24.3	22	38	12	65	B	10	0
603820	18	25.5	23	38	12	100	B	10	0
603821	19	26.8	24	38	14	105	B	10	0
603822	20	28.1	24	38	14	115	B	10	0
603823	21	29.3	25	38	14	128	B	10	0
603824	22	30.4	25	38	14	142	B	10	0
603825	23	31.7	26	40	14	147	B	10	0
603826	24	33.1	28	42	16	165	B	10	0
603827	27	37	30	43	18	180	B	10	0
603828	30	40.7	34	46	22	195	B	10	0
603829	32	43.2	36	46	22	237	B	10	0
621722	36	48	42	46	22	245	B	10	0
609366	3/8"	15	22.9	38	12	55	B	10	0
609367	7/16"	16.3	22.9	38	12	55	B	10	0
609368	1/2"	18.8	22.9	38	12	65	B	10	0
609369	9/16"	20.4	22.9	38	12	65	B	10	0
609370	19/32"	20.4	20.7	38	12	65	B	10	0
609371	5/8"	22.9	21.5	38	12	65	B	10	0
609372	11/16"	25.5	23	38	12	65	B	10	0
609373	3/4"	26.8	24	38	14	105	B	10	0
609374	25/32"	27.9	24	38	14	115	B	10	0
609375	13/16"	29.3	25	38	14	128	B	10	0
609376	7/8"	31.7	26	40	14	142	B	10	0
609377	15/16"	33.1	28	42	16	165	B	10	0
609378	1"	35.3	30	42	16	170	B	10	0
609379	1.1/16"	37	30	43	18	180	B	10	0
609380	1.1/8"	39	32	43	20	190	B	10	0
609381	1.3/16"	40.7	34	46	22	195	B	10	0
609382	1.1/4"	43.2	36	46	22	237	B	10	0

### Date de ambalare

Barcode	Hex Key Icon	Mod de reambalare.					Ambalare pentru transport.			
		A	B	C	Weight	Hand	A1	B1	C1	Weight
603812	10	105	44	43	60	4	93	144	57	365
603813	11	105	44	43	60	4	93	144	57	365
603814	12	105	44	43	70	4	93	144	57	405
603815	13	105	44	43	70	4	93	144	57	405
603816	14	105	44	43	70	4	93	144	57	405
603817	15	105	44	43	70	4	93	144	57	405
603818	16	105	44	43	70	4	93	144	57	405
603819	17	105	44	43	70	4	93	144	57	405
603820	18	105	44	43	105	4	93	144	57	545
603821	19	105	44	43	110	4	93	144	57	565
603822	20	105	44	43	120	4	93	144	57	605
603823	21	105	44	43.4	133	4	93	144	57	657
603824	22	105	44	43	147	4	93	144	57	713
603825	23	105	44	44.6	152	4	93	144	57	733
603826	24	105	44	43	170	4	93	144	57	805
603827	27	105	44	44	185	4	93	144	57	865
603828	30	105	44	45	200	4	93	144	57	925

Mod de reambalare.

Ambalare pentru transport.

		Mod de reambalare.					Ambalare pentru transport.				
		A	B	C			A1	B1	C1		
603829	32	110	44	49,5	242	4	93	144	57	1093	
621722	36	110	44	50	250	4	65	238	59	1125	
609366	3/8"	105	44	43	60	4	93	144	57	365	
609367	7/16"	105	44	43	60	4	93	144	57	365	
609368	1/2"	105	44	43	70	4	93	144	57	405	
609369	9/16"	105	44	43	70	4	93	144	57	405	
609370	19/32"	105	44	43	70	4	93	144	57	405	
609371	5/8"	105	44	43	70	4	93	144	57	405	
609372	11/16"	105	44	43	70	4	93	144	57	405	
609373	3/4"	105	44	43	110	4	93	144	57	565	
609374	25/32"	105	44	43	120	4	93	144	57	605	
609375	13/16"	105	44	43	133	4	93	144	57	657	
609376	7/8"	105	44	43	147	4	93	144	57	713	
609377	15/16"	105	44	43	170	4	93	144	57	805	
609378	1"	105	44	44	175	4	93	144	57	825	
609379	1.1/16"	105	44	44	185	4	93	144	57	865	
609380	1.1/8"	105	44	44	195	4	93	144	57	905	
609381	1.3/16"	105	44	44	200	4	93	144	57	925	
609382	1.1/4"	110	44	44	242	4	93	144	57	1093	