

Capete chei tubulare 3/8" cu 12 laturi - 238/1 12p

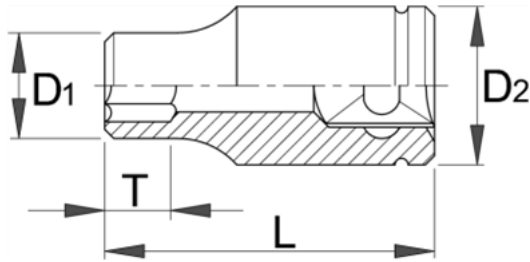

Descriere

- material:crom vanadiu
- forjata, calire si revenire totala
- acoperire cromare conform EN12540
- polizate
- executie in concordanta cu standardul ISO 2725-1 (numai pentru dimensiunea in mm)

Date Tehnice





Barcode	Hex Size	L	D1	D2	T	Weight	Material	Finish	ISO
617122	6	28	10.6	16.9	4	28	B	10	0
616905	7	28	10.6	16.9	4	28	B	10	0
616906	8	28	11.8	16.9	5	29	B	10	0
616907	9	28	13.2	16.9	5	29	B	10	0
616908	10	28	14.5	16.9	6	30	B	10	0
616909	11	28	15.7	16.9	7	29	B	10	0
616910	12	28	16.9	16.9	8	28	B	10	0
616911	13	28	17.9	17.9	8	32	B	10	0
616912	14	28	19.6	19.6	10	39	B	10	0
616913	15	28	21	21	10	46	B	10	0
616914	16	30	21.8	21.8	10	48	B	10	0
616915	17	30	23.4	23.4	10	49	B	10	0
616916	18	30	24.7	21	12	65	B	10	0
616917	19	30	25.8	23	12	73	B	10	0
616918	20	32	27.1	24	12	86	B	10	0
616919	21	32	27.8	25	12	88	B	10	0
616920	22	32	29.5	26	14	105	B	10	0
616921	23	32	31.5	27	14	120	B	10	0
616922	24	32	31.8	28	14	112	B	10	0
616923	1/4"	28	10.2	16.7	8	28	B	10	0
616924	5/16"	28	11.8	16.7	8	29	B	10	0
616925	3/8"	28	14.5	16.7	8	30	B	10	0
616926	7/16"	28	15.7	16.7	8	29	B	10	0
616927	1/2"	28	15.7	17.7	8	32	B	10	0
616928	9/16"	28	15.7	19.5	12	39	B	10	0
616929	5/8"	30	15.7	21.7	12	48	B	10	0
616930	11/16"	30	15.7	23.3	12	59	B	10	0
616931	3/4"	30	25.7	23	14	73	B	10	0
616932	13/16"	32	27.7	25	14	88	B	10	0
616933	7/8"	32	29.5	26	14	105	B	10	0
616934	15/16"	32	31.7	28	14	112	B	10	0
616935	1"	32	33.7	30	14	132	B	10	0

Date de ambalare

Barcode	Hex Size	Mod de reambalare.						Ambalare pentru transport.			
		A	B	C	Weight	Hand	A1	B1	C1	Weight	
617122	6	100	44	35	33	4	83	131	55	257	
616905	7	100	44	35	33	4	83	131	55	257	
616906	8	100	44	35	34	4	83	131	55	261	
616907	9	100	44	35	34	4	83	131	55	261	
616908	10	100	44	35	35	4	83	131	55	265	
616909	11	100	44	35	34	4	83	131	55	261	
616910	12	100	44	35	33	4	83	131	55	257	
616911	13	100	44	35	37	4	83	131	55	273	
616912	14	100	44	35	44	4	83	131	55	301	
616913	15	100	44	35	51	4	93	144	57	329	
616914	16	100	44	36	53	4	93	144	57	337	
616915	17	100	44	36	54	4	93	144	57	341	
616916	18	100	44	36	70	4	93	144	57	405	
616917	19	100	44	36	78	4	93	144	57	437	
616918	20	100	44	37	91	4	93	144	57	489	
616919	21	100	44	37	93	4	93	144	57	497	
616920	22	100	44	37	110	4	93	144	57	565	
616921	23	100	44	37	125	4	93	144	57	625	
616922	24	100	44	37	117	4	93	144	57	593	
616923	1/4"	100	44	35	33	4	94	150	59	257	
616924	5/16"	100	44	35	34	4	94	150	59	261	

Mod de reambalare.

Ambalare pentru transport.

 		Mod de reambalare.			Ambalare pentru transport.					
		A	B	C			A1	B1	C1	
616925	3/8"	100	44	35	35	4	94	150	59	265
616926	7/16"	100	44	35	34	4	94	150	59	261
616927	1/2"	100	44	35	37	4	94	150	59	273
616928	9/16"	100	44	35	44	4	94	150	59	301
616929	5/8"	100	44	36	53	4	94	150	59	337
616930	11/16"	100	44	36	64	4	94	150	59	381
616931	3/4"	100	44	36	78	4	94	150	59	437
616932	13/16"	100	44	37	93	4	94	150	59	497
616933	7/8"	100	44	37	110	4	94	150	59	565
616934	15/16"	100	44	37	117	4	94	150	59	593
616935	1"	100	44	37	137	4	94	150	59	673